

I-280 Southbound Ocean Ave Off-Ramp Improvement Project



San Francisco
County Transportation
Authority

Community Advisory Committee - Agenda Item 13
June 25, 2025

Project Location

Southbound I-280 Off-Ramp

The study area extends from the Ocean off ramp to Howth Street, along the north side of Ocean Avenue.



Existing Challenges

- High-speed, uncontrolled off-ramp
- Limited visibility and long distance hamper the opportunities to cross the ramp
- Lane merging creates safety risks for all travelers
- Bike lane transitions to shared lane at off-ramp
- Grade difference between the Muni tracks and the vehicle lanes
- Future growth will increase travel in the area



Project History

The Balboa Park Station Area Circulation Study (2014) recommended redesigning and signaling the Ocean Ave off-ramp to improve pedestrian and bicyclist safety.



Recommendations along Ocean Ave

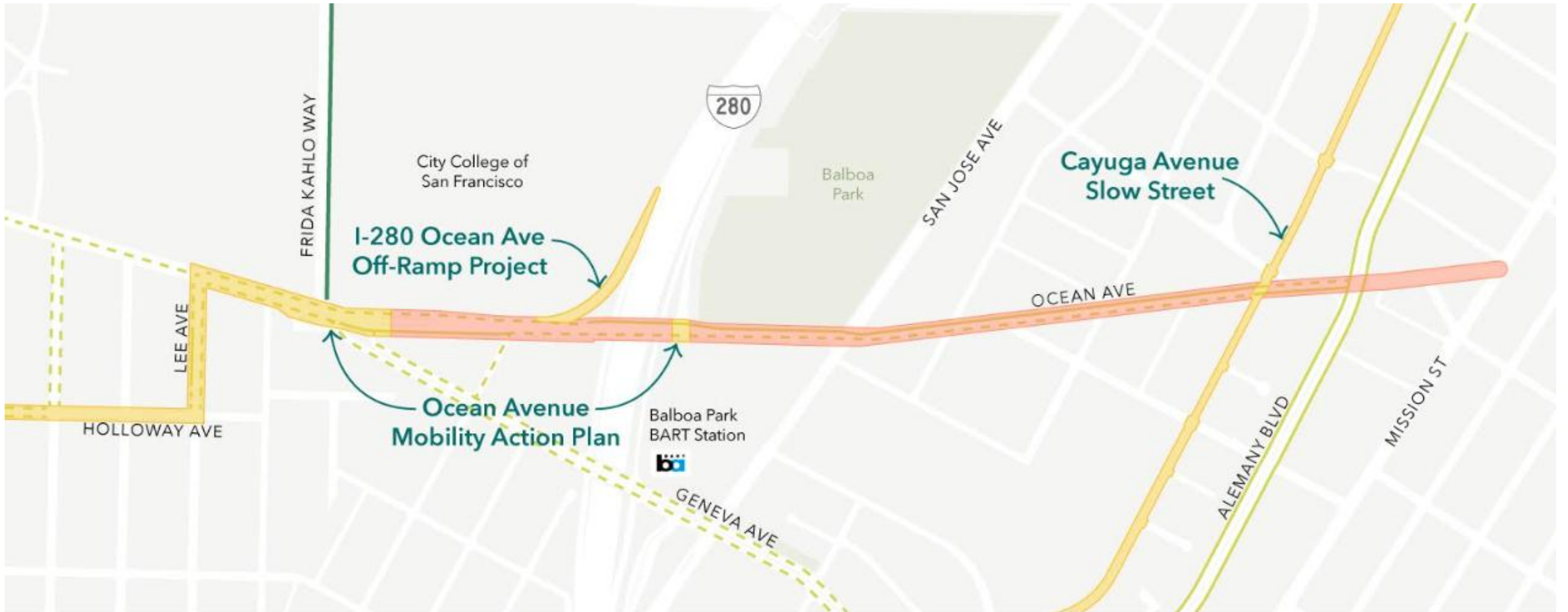

Existing design from another study

No existing design

Class II Bike Lane
(Striped one-way
bike lane)

Class III Bike Route
(Shared bike/
vehicle travel lane)

Class IV Separated Bikeway
(Physically separated on-
street bike lane)



San Francisco
County Transportation
Authority

Community Outreach (2016-2020)

Findings from previous outreach through the environmental process included:

- Address congestion
- Improve access for people walking and biking
- Consider a mid-block crosswalk and left turns at the off-ramp
- Understand construction impacts and project priority

Project Map

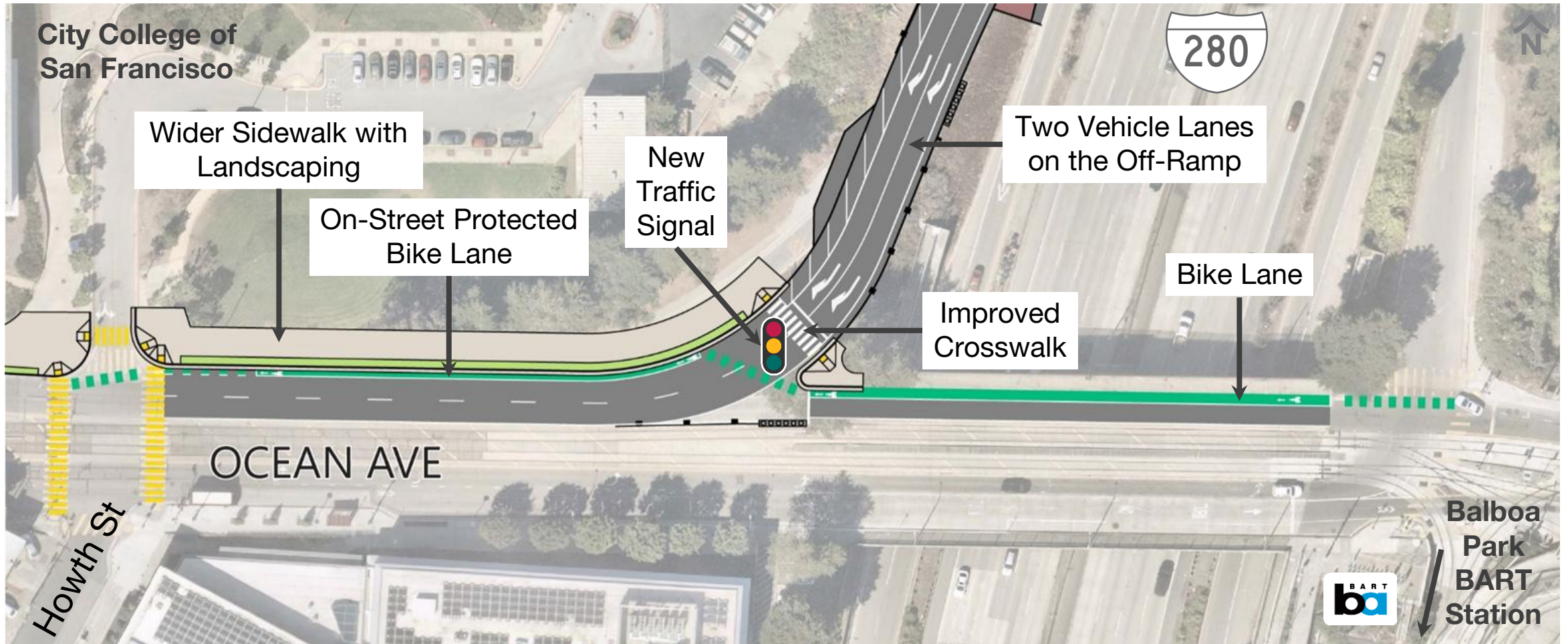

San Francisco
County Transportation
Authority

Implementation

- Estimated construction cost: \$14-17M
- Minimal construction impact along Ocean Ave
- Short term roadway closure of the off-ramp (Caltrans property)

Project Timeline

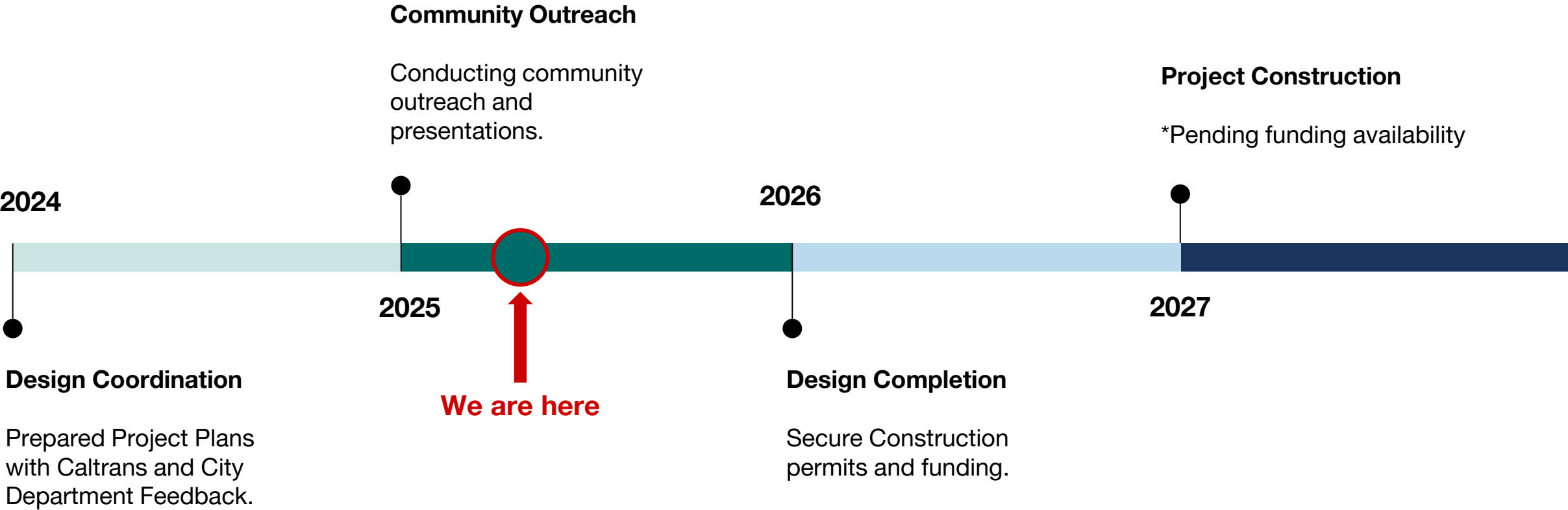

Thank you.

Project website: sfcta.org/projects/280-Ocean-Ave-Ramp

Aliza Paz

Principal Transportation Planner

aliza.paz@sfcta.org

415-522-4803 office



San Francisco
County Transportation
Authority



sfcta.org/stay-connected