

# I-280 Southbound Ocean Ave Off-Ramp Improvement Project



San Francisco  
County Transportation  
Authority

Transportation Authority Board - Agenda Item 7  
June 24, 2025

# Project Location

## Southbound I-280 Off-Ramp

The study area extends from the Ocean off ramp to Hawth Street, along the north side of Ocean Avenue.



# Existing Challenges

- High-speed, uncontrolled off-ramp
- Limited visibility and long distance hamper the opportunities to cross the ramp
- Lane merging creates safety risks for all travelers
- Bike lane transitions to shared lane at off-ramp
- Grade difference between the Muni tracks and the vehicle lanes
- Future growth will increase travel in the area





# Project History

The Balboa Park Station Area Circulation Study (2014) recommended redesigning and signaling the Ocean Ave off-ramp to improve pedestrian and bicyclist safety.

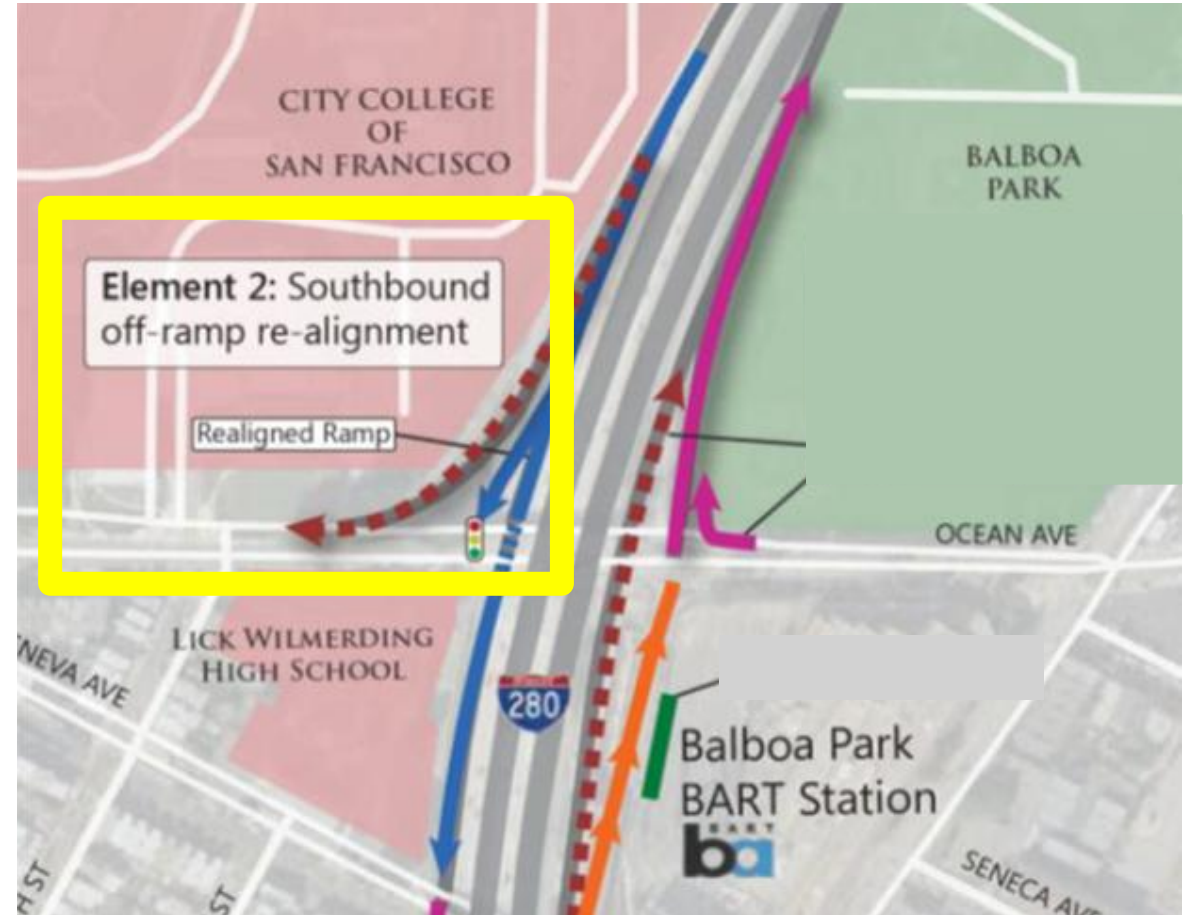

# Recommendations along Ocean Ave

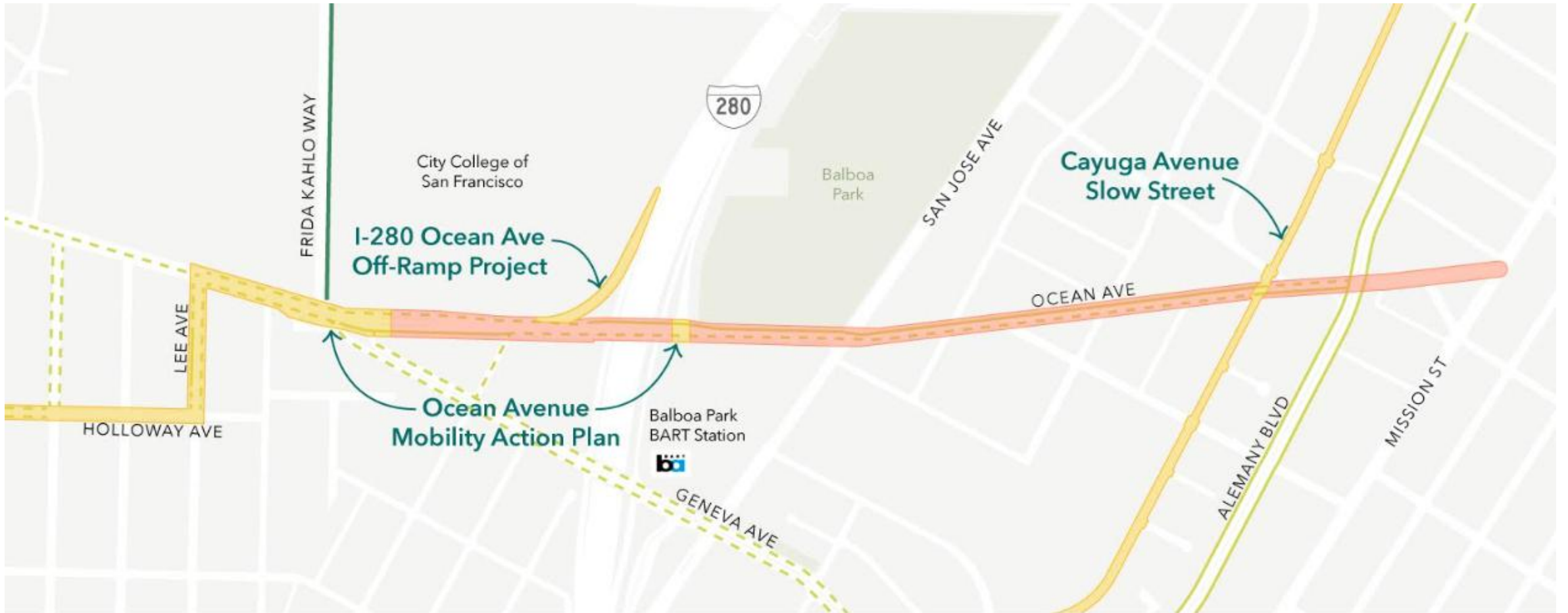

Existing design from another study

No existing design

Class II Bike Lane  
(Striped one-way  
bike lane)

Class III Bike Route  
(Shared bike/  
vehicle travel lane)

Class IV Separated Bikeway  
(Physically separated on-  
street bike lane)



San Francisco  
County Transportation  
Authority

# Community Outreach (2016-2020)

**Findings from previous outreach through the environmental process included:**

- Address congestion
- Improve access for people walking and biking
- Consider a mid-block crosswalk and left turns at the off-ramp
- Understand construction impacts and project priority



# Project Map

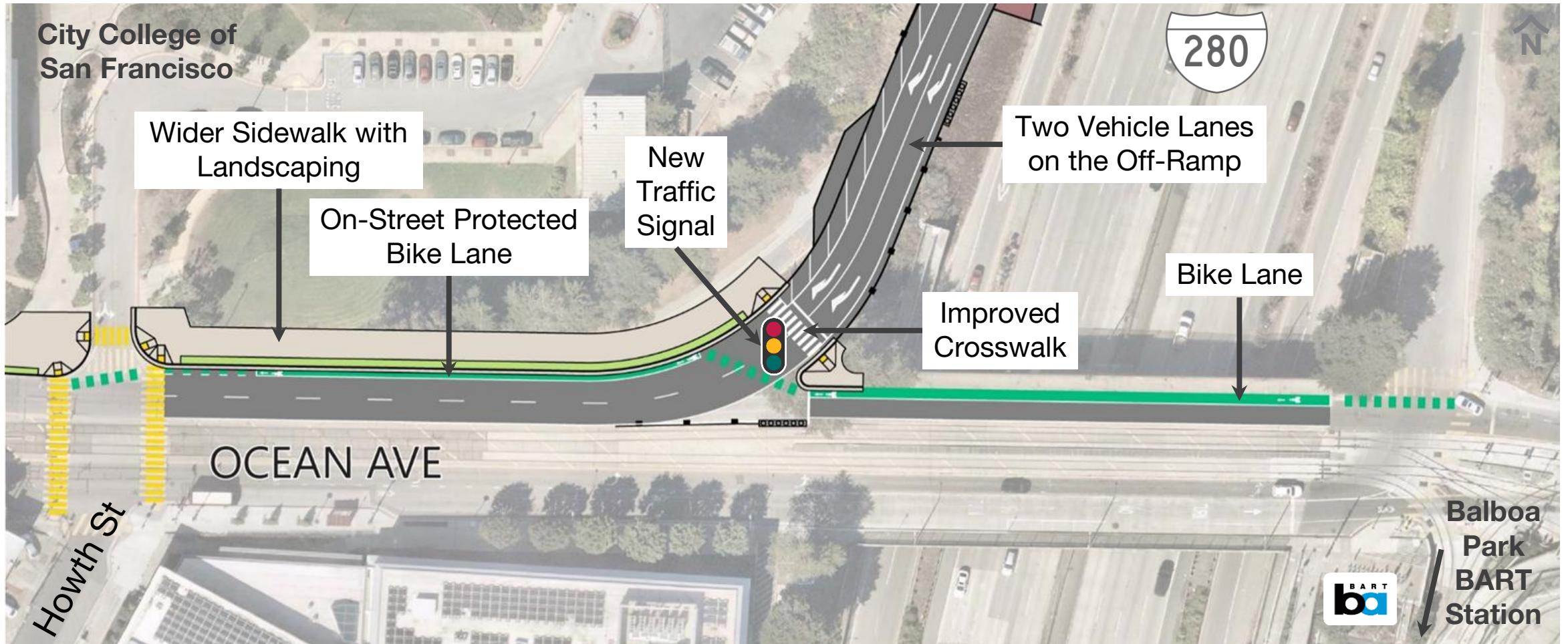

San Francisco  
County Transportation  
Authority

# Implementation

- Estimated construction cost: \$14-17M
- Minimal construction impact along Ocean Ave
- Short term roadway closure of the off-ramp (Caltrans property)



# Project Timeline

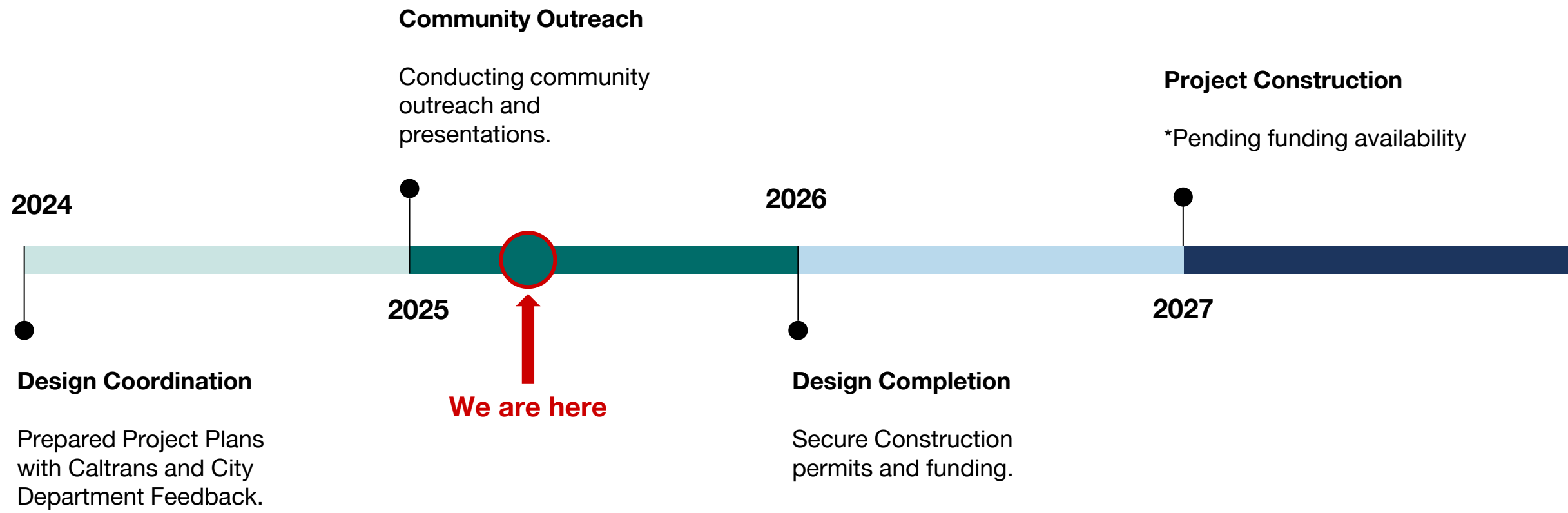

# Thank you.

**Project website:** [sfcta.org/projects/280-Ocean-Ave-Ramp](https://sfcta.org/projects/280-Ocean-Ave-Ramp)

**Aliza Paz**

Principal Transportation Planner

[aliza.paz@sfcta.org](mailto:aliza.paz@sfcta.org)

415-522-4803 office



San Francisco  
County Transportation  
Authority



[sfcta.org/stay-connected](https://sfcta.org/stay-connected)